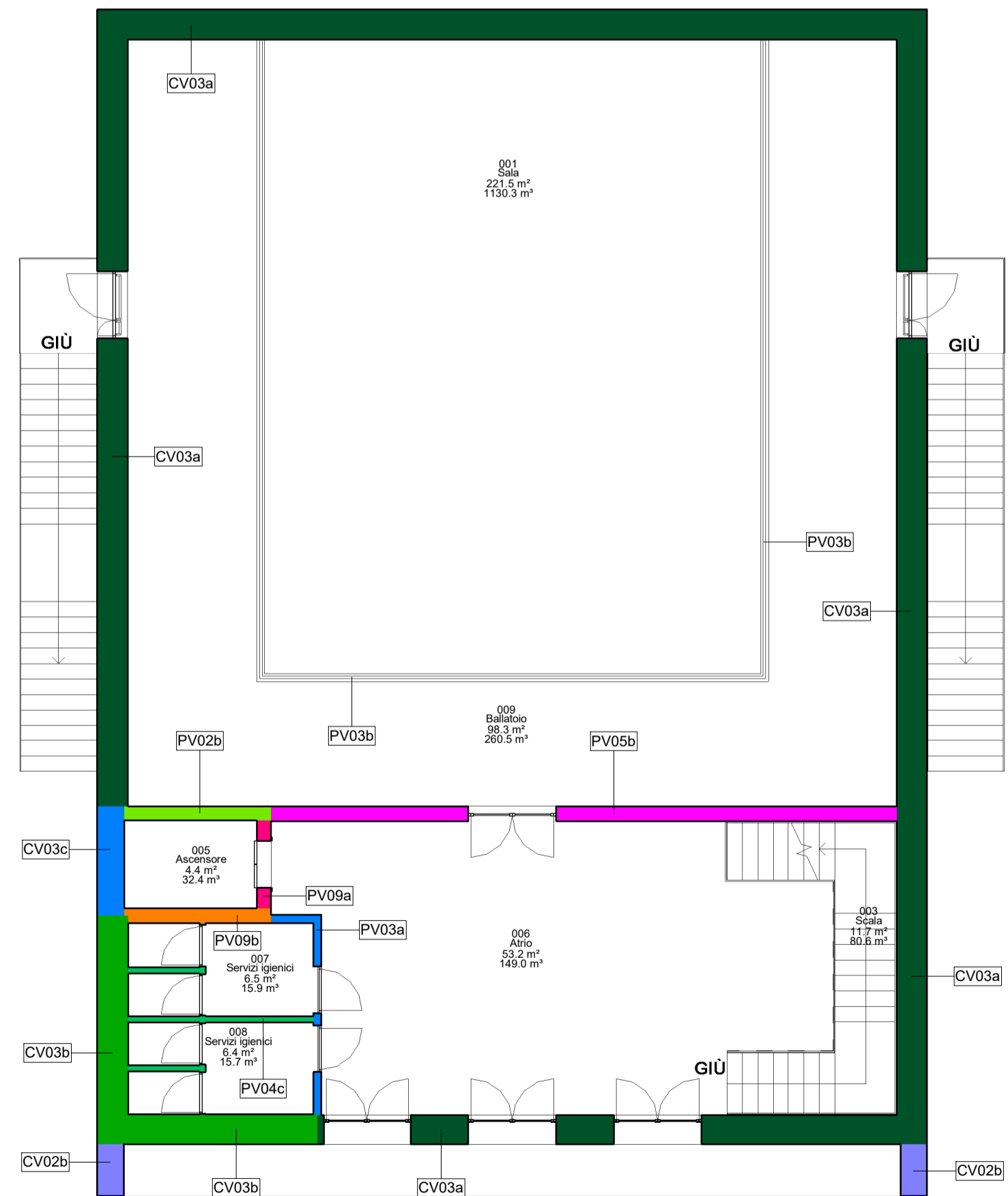
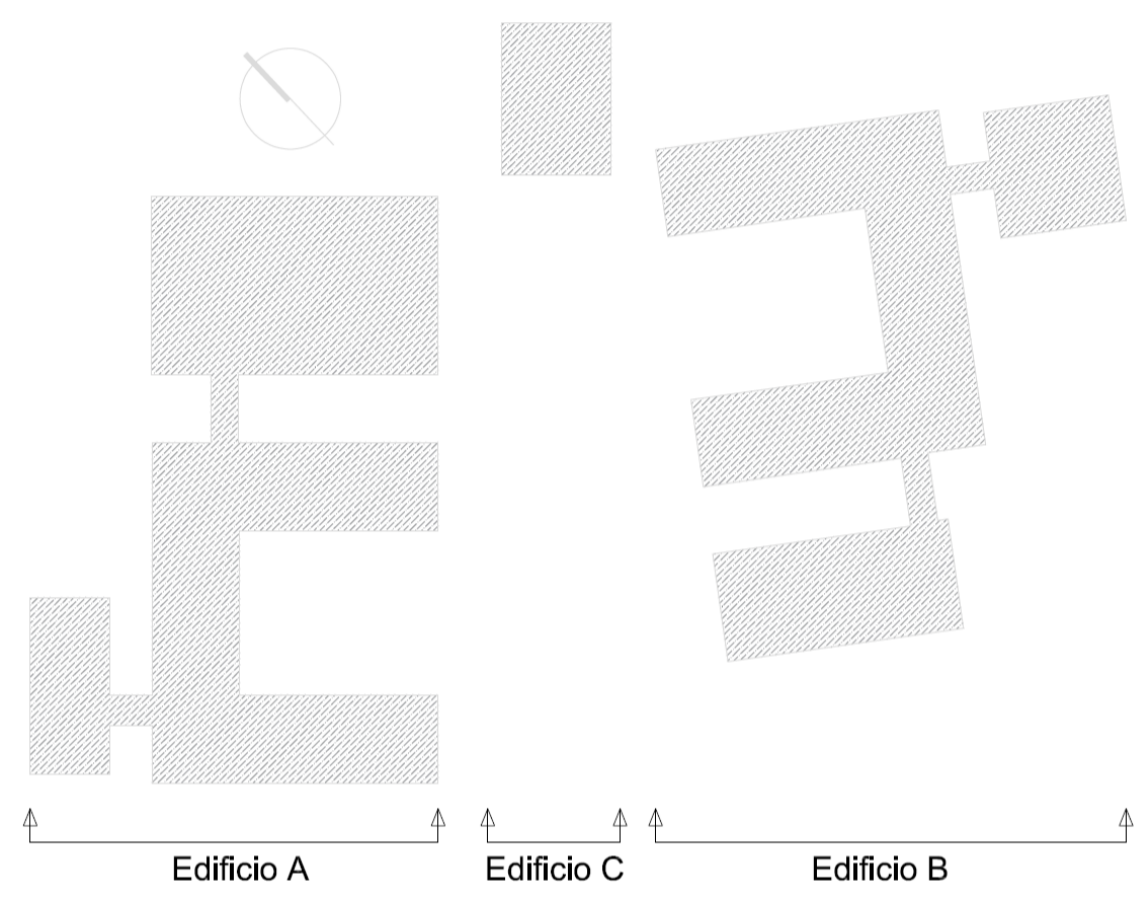

Table with 2 columns: Color swatch and description (CV01a to CV04b) detailing construction materials and specifications for various wall types.

Table with 2 columns: Color swatch and description (CV05a to PV03a) detailing construction materials and specifications for various wall types.

Table with 2 columns: Color swatch and description (PV03b to PV06c) detailing construction materials and specifications for various wall types.

Table with 2 columns: Color swatch and description (PV07 to PV13) detailing construction materials and specifications for various wall types.



COMUNE DI INVERUNO



NUOVO PLESSO SCOLASTICO - VIA IV NOVEMBRE

PROGETTO DEFINITIVO

UFFICIO TECNICO COMUNE DI INVERUNO

R.U.P.: Geom. Pietro Tiberti

Progettista: Arch. Claudia Soldati

Table with 2 columns: Client information (CONSULENTE SCIENTIFICO, RESPONSABILE SCIENTIFICO, GRUPPO DI LAVORO) and project details (Titolo progetto, BIMGroup, RESPONSABILE SCIENTIFICO, GRUPPO DI LAVORO).

Table with 2 columns: Project description (Oggetto: Progetto Architettonico - Edificio C - Pianta piano primo...) and drawing identification (Tavola n°: A-49).